

Haslar Marina

Reception and office building

When the owners of Haslar Marina required a new office building they commissioned Plus Design and Build to construct it for them.

Haslar Marina is a modern purpose-built marina situated at the eastern end of the Solent, near Gosport. In order to provide yachtsmen with an efficient support service and 24-hour security surveillance, the owners, Dean and Reddyhoff, decided to commission a new office building. This was to be sited in a prominent position to the left of the main access brow.

The other buildings on the Haslar Marina complex are built from natural materials with timber boarding, slate and clay tiled roofs and therefore combine to provide an attractive 'New England' flavour. A timber framed office building that respected the environment and made imaginative use of natural materials was therefore essential if it was to meet strict local planning restrictions.

Plans were drawn up, planning permission obtained and invitations to tender sent out to companies specialising in supplying buildings for environmentally sensitive areas. Plus Design and Build (PDB) was eventually selected as the successful contractor:

A low ring-beamed structure on piled foundations, the new 110 sq. metre office building is attractive and very practical. It uses a highly insulated timber frame with a rendered blockwork exterior and tiled roof with a feature lantern.

It was designed with a curved façade to give staff almost uninterrupted views over the whole marina allowing easy monitoring of day-to-day activity.

The tight radius of the timber frame presented PDB with a number of challenges. The timber frame had to be fabricated on the curve and the roof tiles cut to shape on every course to maintain tile bonding.

A lantern roof clock feature has also been included. The result is not only visually pleasing but also provides a dramatic, open feel to the reception area. Landscaping around the office building, which also includes specially built planters, is in keeping with the coastal character of the site.

Client: Haslar Marina
Location: Gosport, Hants



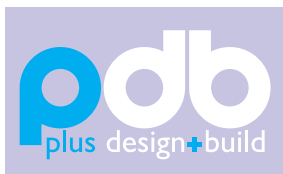
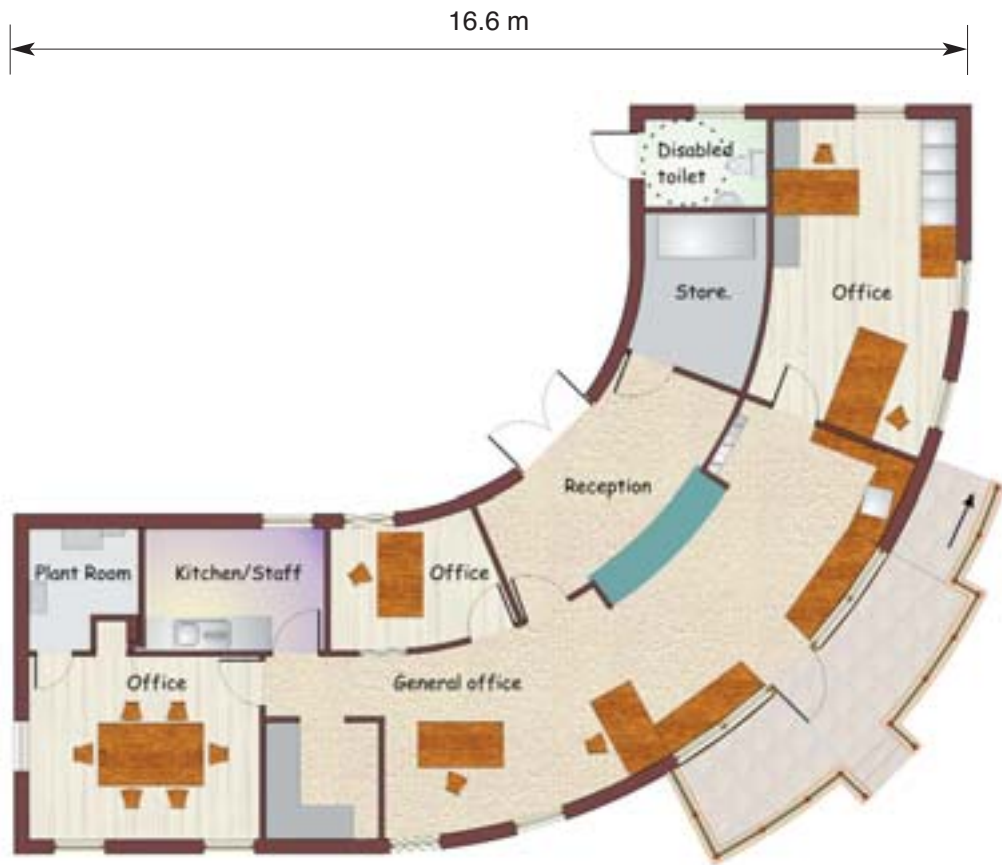

Plus Design and Build Limited
Riverside Business Park Bakewell Derbyshire DE45 1GS
01629 816770 admin@plusdesignbuild.co.uk
www.plusdesignbuild.co.uk